

6th Gen VFR Headlamp bulb replacement – How to

So I had a dead main beam bulb. Here's how I fixed it.

Step one remove the relevant plastic end cover at the side of the instrument panel.



Getting this panel out without breaking anything is the most difficult task, so take your time. You will find access a lot easier if you put the bike on its centre stand, turn the steering towards the side you are working on, and protect the tank with a cloth, as you'll probably end up sticking bits on it.

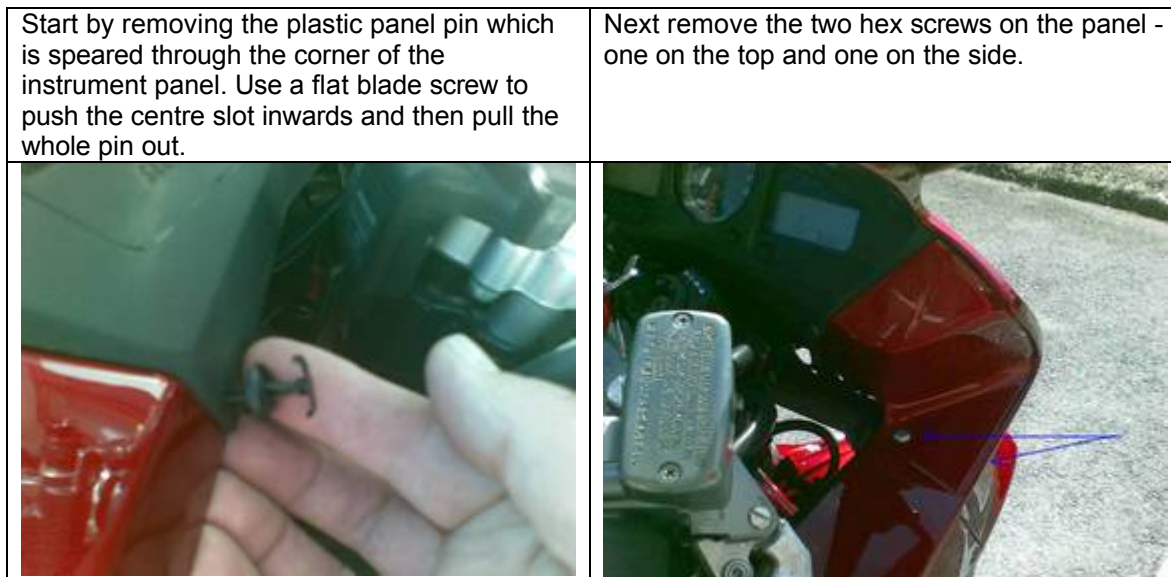

Once the fixings are out, free the outboard end of the panel and carefully free the panel from the various lugs/clips working towards the instrument panel.



Now free the bulb/bulb holder unit
Press in on the curly silver metal bit and then
push it upwards to free it from the catch



Rotate the catch to the side and lift the
bulb/holder out



Here's what the bulb looks like when its still
mounted in its holder



Slide a knife between the bulb and bulb holder
to free the H7 bulb



Refitting is basically the reverse of the above. But take note of the following points:-

Its OK to touch the bulb holder BUT avoid touching the glass bit of the replacement bulb with your fingers
– or you'll be doing this again very soon!!!

Ensure you fit the bulb into the holder correctly
– The flat bits must be lined up.



If it wont fit snugly into the square cut out at
the top of the lamp housing – check you've
fitted the bulb correctly in the holder!



If you need to change the dipped beam bulbs basically the same instructions apply BUT as they are located a lot further down behind the instruments, they can be a real hassle to get to, especially if you've got large hands. Access to the dip-beam bulbs is significantly improved if you first remove the main beam bulb and rubber gaiter!

Good luck